

Service Bulletin

No. 92-021

TIMELINE VISTA, INC.
1755 LA COSTA MEADOWS DRIVE, SUITE B
SAN MARCOS, CA 92069
TEL. 760-761-4440
(FAX 760-761-4449)
SUPPORT@DIGAUDIO.COM

- OPTIONAL
- RECOMMENDED
- MANDATORY

SSU Ground Lug Modification

DATE: 6/30/93
MODEL: Lynx System Supervisor
REVISION: N/A
SERIAL NO: All units prior to S/N 128
SOFTWARE: N/A

REQUIRED TOOLS:

Static safe workstation	Phillips screwdriver
Grounding wrist strap	Drill with 1/8" bit
Crimp tool	

REQUIRED PARTS:

Wire assembly #1 - ground lug to fast-on
Wire assembly #2 - ground lug to butt splice
3/8" Button head screw
#4 Ext tooth washer
#4 Kep nut

DESCRIPTION:

This modification to the System Supervisor Unit needs to be made to meet AC chassis ground safety requirements.

PROCEDURE:

1. Turn off the System Unit and disconnect all cables from the rear panel. Place the System Unit on a static safe workstation. Ground yourself on the workstation anti-static mat.
2. Remove the eight phillips screws securing the top cover of the System Unit. Position the unit so that the back panel faces you and remove the cover. See Figure 1.

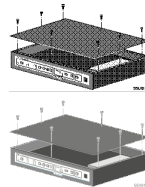

Figure 1. Remove the Top Cover

PROCEDURE (continued):

3. Mark position indicated in Figure 2 on the rear panel of the Supervisor.
4. Using a 1/8" drill bit, drill a hole in the panel. Take care not to allow metal shavings to fall in to the System Supervisor Unit.

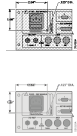

Figure 2. Drilling Location

5. Disconnect green wire from the power supply module. Cut fast-on from green wire and strip back 1/4".
6. Crimp butt splice on assembly #2 to green wire.
7. Connect fast-on from assembly #1 to power supply module.
8. Bolt both wire assemblies to the rear panel as shown in Figure 3.

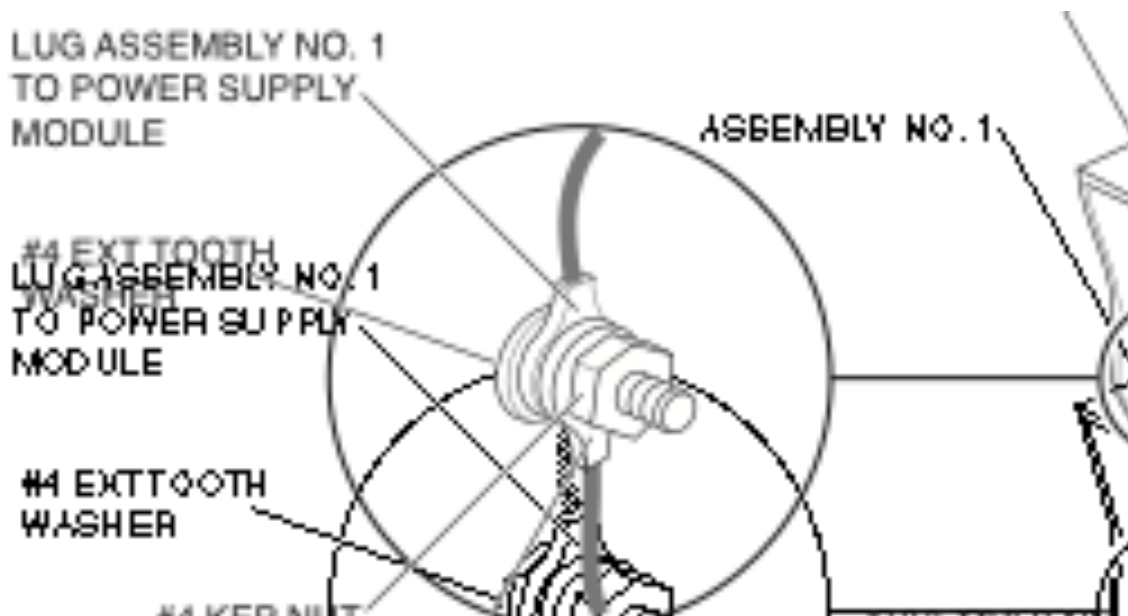

Figure 3. Wiring Diagram

9. Recheck all connections and replace the tope cover on the SSU.